

Instructional Guide

Qi Wireless Charger

1. Connect Micro USB power adapter to electrical outlet.
2. Connect the Wireless Charger to Micro USB power adapter.

Use adapter native to your phone to enable Fast Charging.

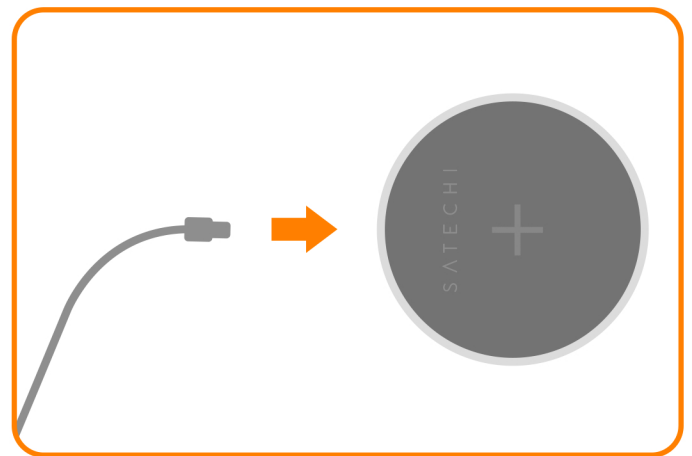
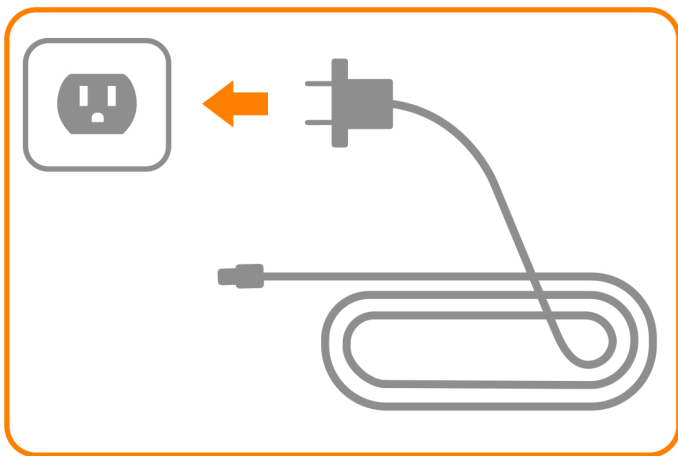

3. Place the phone with Wireless Charging enabled on the center of the charging pad.

*Blue LED indicates charging device.
Green LED indicates fully charged device.*

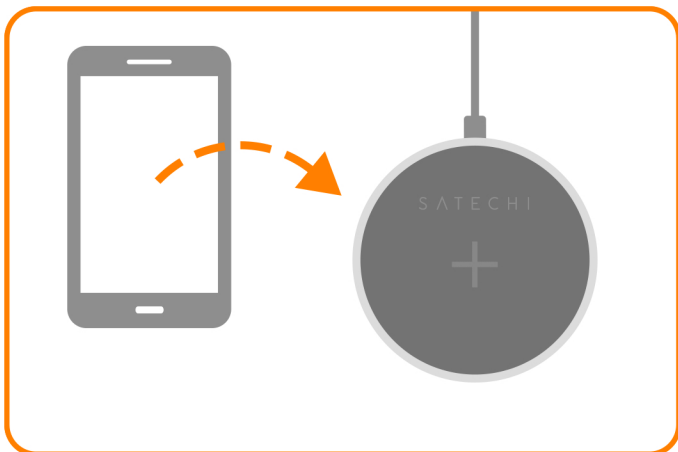

4. When the phone is fully charged turn off the Wireless Charger by unplugging USB adapter from electrical outlet or Micro USB from the device.

