

# Assembly instructions

[31045] Folding workshop crane



# Assembly instructions

After opening the package, please check if the parts in Fig. A are all included firstly. Totally 6 pcs (2 x No. 16).

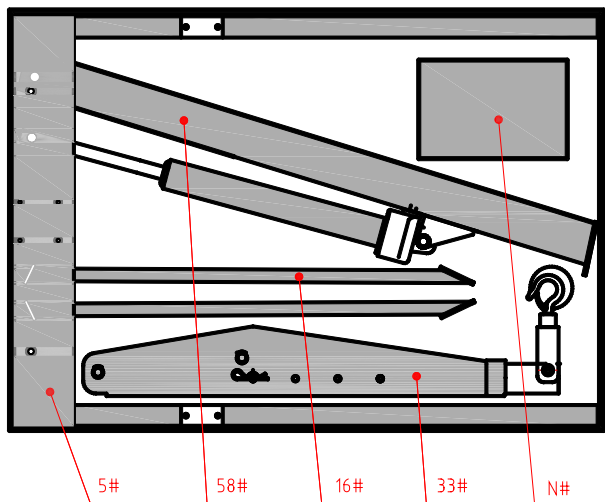

Fig. A

- 5#: Base
- 58#: Post
- 16#: Support
- 33#: Boom
- N#: Spare parts carton

## Installation steps

### Step 1

Fig.1  
Open spare parts carton N#, take out 4# (Front wheel), loose 1#(Nut), then fasten 4# (Front wheel) into 5# (Base) holes, put 2# (Washer) above the hole, tighten 1# (Nut)

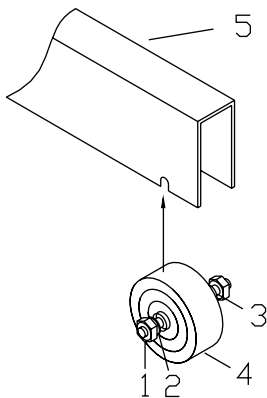

Fig. 1

### Step 2

Fig.2  
Take out 6A# (Steering wheel) from spare parts carton N#, loose 15# (Screw), 14# (Spring Washer), 13# (Washer), align 6A# (Steering wheel) and 5# (Base) hole, assemble 13# (Washer), 14# (Spring Washer), 15# (Screw) according to Fig. 2 in order, finally tighten 15# (Screw).

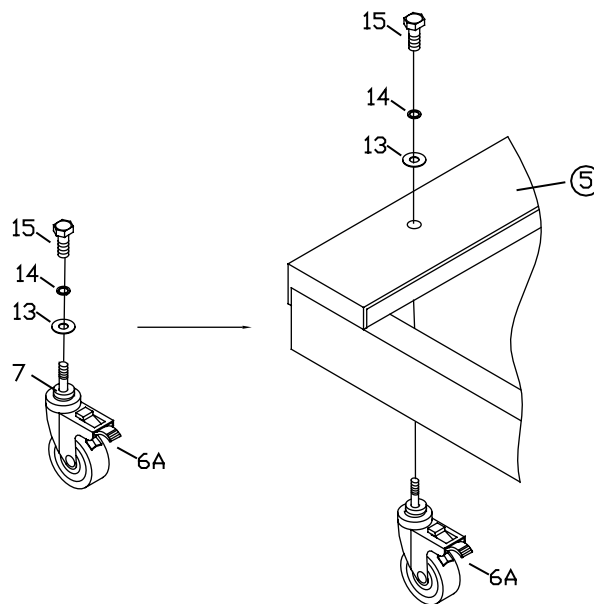

Fig. 2

### Step 3

Fig. 3-2  
Take out 9# (Nut), 10# (Spring Washer), 11# (Washer), 12# (Screw M12X85) from spare parts carton N#. Connect 58# (Post) and 5# (Base), with 12# (Screw), 11# (Washer), 10# (Spring Washer) and 9# (Nut).  
Don't twist 12# (Screw) too tightly.

**(Note: During this step, please make sure all parts of 58# post are stable to avoid any accident and injury)**

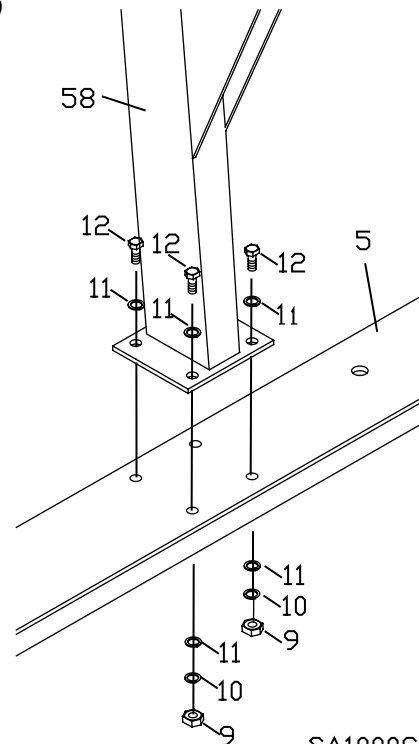

Fig. 3-2

SA1000C

#### Step 4

Fig.4

Take out 16# (Support) from the package, take out 21# (Screw), 1# (Nut), 2# (Washer) from the spare parts carton N#. Loose 8# (Screw), 2# (Washer), 21# (M10X80 Screw), 8# (M10X20 Screw) on 5# (Base), assemble according to Fig. 4 in order. Don't twist the screws too tightly firstly. After assemble all bolts, then tighten 21# (Screw), 8# (Screw), 12# (Screw) one by one.

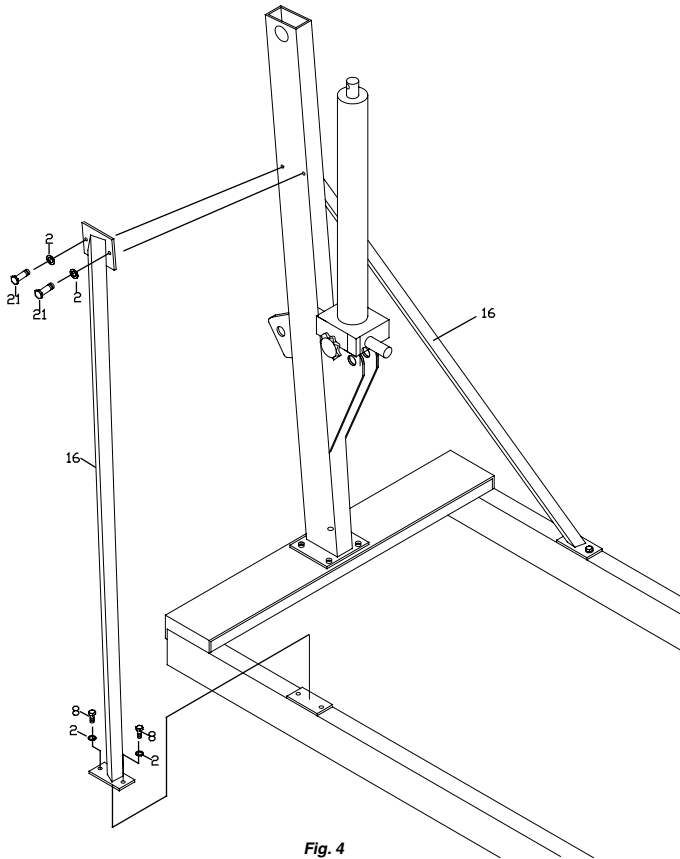

Fig. 4

#### Step 5

Fig.5

Take out 33# (Boom) from package, then take out 57# (Snap ring), 56# (Pin), 52# (Spacer), 55# ( Pin) in order. Fasten 33# (Boom) end into 58# (Post). Align the holes, then assemble 56# (Pin), fasten with 57# (Snap ring).

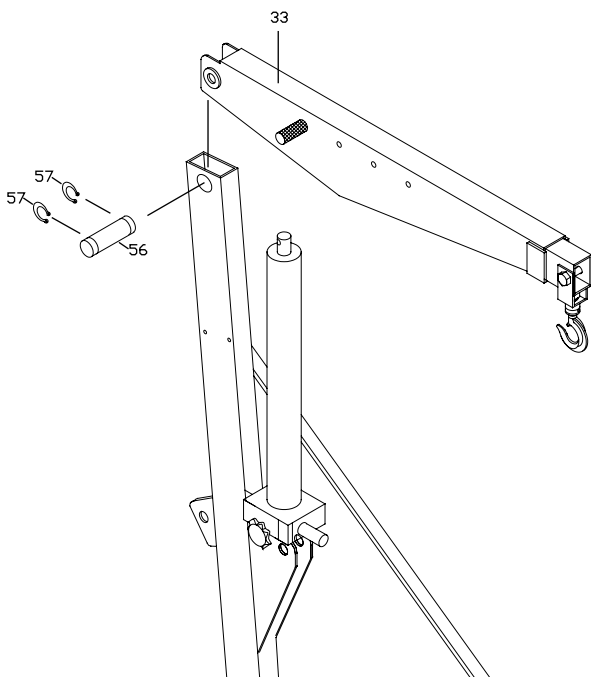

Fig. 5

#### Step 6

Fig. 6

Pull 51A# (Ram assembly) piston rod upwards to expose the hole, align 33# (Boom) and 51A # (Ram assembly) piston rod hole, then assemble 55# (Pin) and 52#(Spacer). Assemble 52# (Spacer) on 33# (Boom) the inside side, fasten 57# (Snap ring).

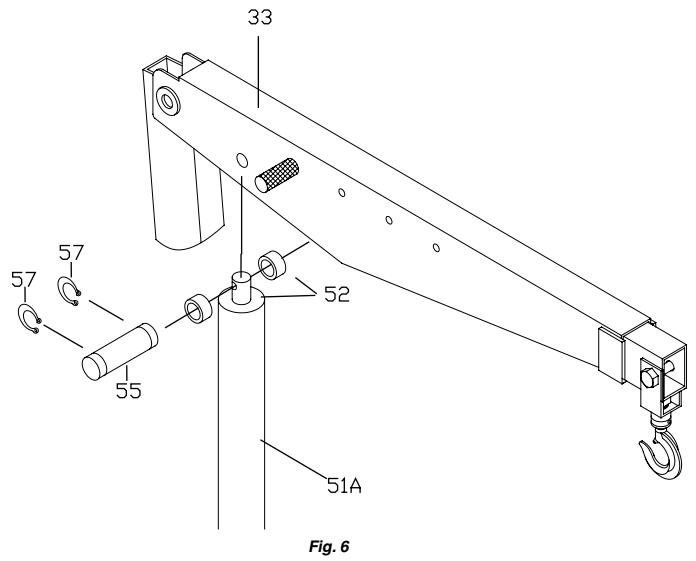

Fig. 6

#### Step 7

Fig.7

Loose 28# (Washer), 29# (Screw) of 58# (Post), take out 27# (Handle) from spare parts carton N#, align 27# (Handle) and 58# (Post) holes, assemble 28# (Washer), 29# (Screw), tighten 29# (Screw). Installation is complete.

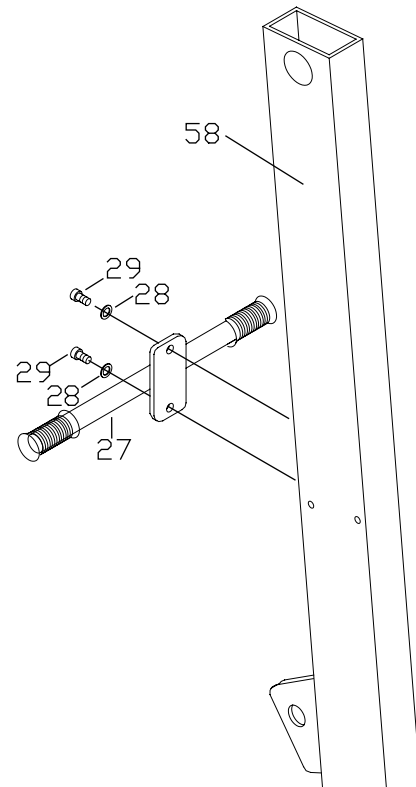

Fig. 7